

Installation and Instruction Manual for Infrared Heaters

HEAT
outdoors

Contents

Safety and operating instructions 3

Scope of supply 4

Installation instructions 5

Initial operation..... 10

Cleaning instructions..... 10

Troubleshooting 12

Guarantee conditions..... 13

Additional instructions 14

Appendices

- Appendix 1: Surface mounted heaters
Technical data, safety distances AX
- Appendix 2: Ceiling mounted heaters
Technical data, safety distances AX
- Radiation diagrams AX

Safety and operating instructions

Please observe the following instructions:

Carefully read through the instruction manual prior to installation and store the manual safely.

This heater can be used by children aged 8 years or older and persons with reduced physical, sensory or mental capabilities or lack of experience and knowledge, provided they have been given supervision or instruction regarding the safe use of the device and that they understand the resulting risks. Children must not play with the heater. Cleaning and user maintenance must not be performed by unsupervised children. Children younger than 3 years old must be kept away from the heater unless they are continuously monitored. Children older than 3 and younger than 8 years may only switch the heater on and off if they are monitored or have been taught how to use the heater safely and have understood the resulting dangers; this provided that the heater is placed or installed in its normal place of use. Children older than 3 and younger than 8 years must not plug the heater into the wall socket, adjust the heater, clean the heater and/or perform any user maintenance.

Caution - Some parts of this product can become very hot and cause burns. Special care is required when children and vulnerable persons are present.

- Installation tasks must be properly carried out by a qualified person in accordance with VDE 0100 installation instructions (if applicable, also including Parts 559 and 701).
- When carrying out any work, always switch the system to a zero-volts state (disconnect mains plug; circuit-breaker off). Switch on the heater only after all cables have been completely connected.
- The heater must be protected with at least a 16A (slow) fuse.
- Do not install directly under sockets, junction boxes, switches or electrical cabling.
- Electrical sockets may only be located in the positions specified in Appendix 1.
- Do not mount the radiant heater close to curtains or combustible materials in accordance with VDE 0100, Part 559.
- If being used in wet rooms, observe the installation instructions, VDE 0100, Part 701. Heaters must be installed in bathrooms such that the switch cannot be touched by a person in the bath or under the shower.
- Never leave the heater unattended.
- Do not cover the heater when it is switched on or still hot; there is a risk of fire.

- This heater is not equipped with a room temperature control unit and must not be used in small rooms that are inhabited by people who cannot leave the room independently, unless constant supervision is ensured.
- To adjust the radiation direction, switch the heater off and allow to cool.
- Do not look directly at an operating IR halogen lamp for a long period and from a short distance.
- IR halogen lamps are sensitive to direct skin contact (do not touch with bare fingers). Grease or other contamination can be removed with an alcohol-soaked cloth.
- To maintain the service life of the IR halogen lamp, it must be protected against vibrations, impacts and contaminants such as acids, ammonia, cement dust, etc.
- The IR halogen lamp must be protected against mechanical loading. It must be replaced, if discolouration (dark spots, deformation) becomes apparent or the rated life time is reached.
- Repair work (replacement of a defective power lead or a defective heating tube or the like) must only be carried out by the customer service of the manufacturer or an authorised dealer.
- Cleaning and maintenance work must only be carried out by adults with sufficient expertise.

Scope of supply

IR radiant heater

Bracket fitted on the heater or included in the set

Installation and Instruction Manual

Installation instructions

- The heater must only be installed using suitable fastenings (e.g. use M6x60 bolts with steel anchors in a stone or concrete substrate) on a firm, load-bearing, standard, flame-resistant or non-combustible substrate.
- If heater and socket are not installed on the same surface, it must be ensured that the field of radiation cannot be directed towards the socket. Failing this, it must be ensured that the socket cannot heat up to more than 70°C during heater operation.
- When mounted on a sloping ceiling, IR radiant heaters must be fitted with a „bottom“ power cord arrangement.
- The safety distances given in Appendixes 1 and 2 must be observed.
- The area in which the heat acts can be estimated from the radiation diagram (Appendix 3). The diagram shows the sizes of the irradiated areas at various distances from the radiant heater and in each case the maximum radiation intensity.
- Installation height: at least 1.80 m above the ground

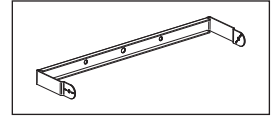

1. For radiant heaters with a bracket

- Fasten the bracket taking into consideration the safety distances (Appendix 1) and safety and operating instructions.
- Unscrew the star grip nuts and hexagon nut from the threaded spindles
- Mount the heater while slightly bending the bracket
- On one side, screw the hexagon nut on to the threaded bolt and tighten against the bracket
- Set the radiating angle as required
- Tighten the M6 nut with a 10 mm open-ended spanner.
- Screw the star grip nuts in place on both sides.

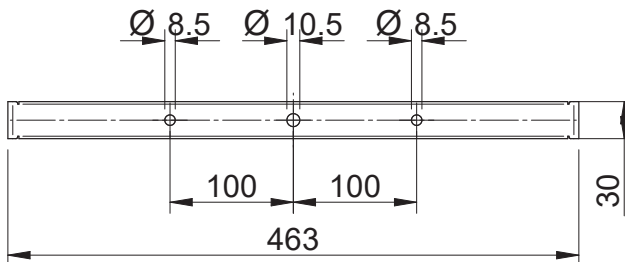
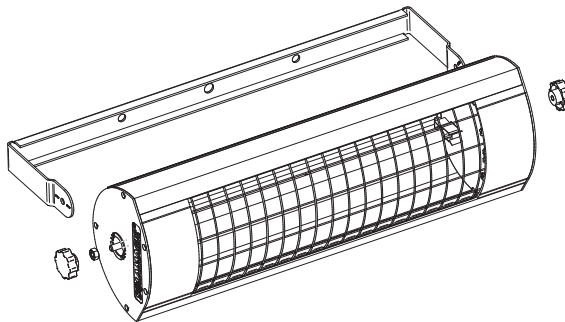

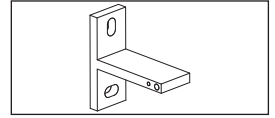

2. For radiant heaters with a T-bracket

- Mount the T-bracket with the underlying silicone plate on the fastening surface using 2 screws while adhering to the safety distances and safety instructions (see Appendix 1)
- Centre the clamping slide on the heater and secure by tightening the clamping screws.
- Position the heater on the T wall bracket using the clamping slide. Insert the M6 screws, complete with 6.4 mm serrated washer, on the sides through the clamping slide into the T wall bracket, then manually tighten.
- Position the heater so that it radiates in the desired direction and then tighten the two M6 screws using a 5 mm Allen key.

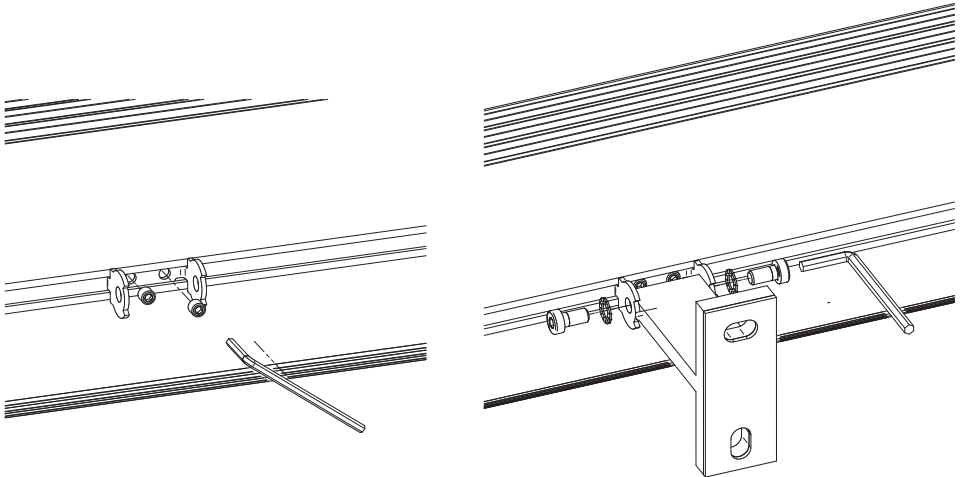

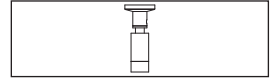

3. For radiant heaters with pivoting hinges

- Determine the appropriate mounting separation of the pivoting hinges on the heater.
- Secure the ceiling plates at the selected separation using suitable fasteners on the wall/ ceiling.

ATTENTION!

With ceiling mounting the supplied insulating washers must be installed between ceiling and ceiling plate.

- Tighten the hinges on the t-nuts until they can no longer move relative to the heater, tighten the M3 grub screws.
- Adjust the hinges until the desired tilting direction is achieved.
- Position and tighten the M5 grub screws in the ceiling plates.

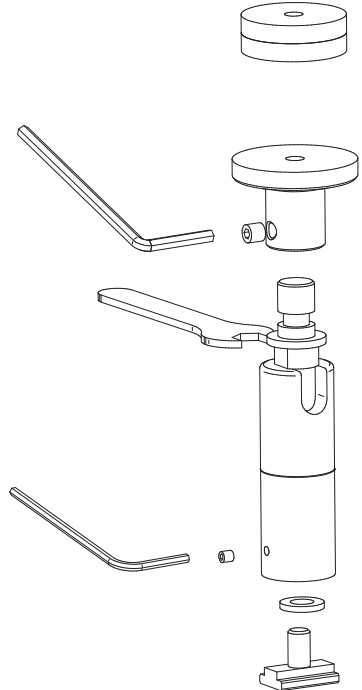

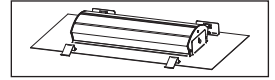

4. For radiant heaters with a ceiling installation frame

General instructions

- The installation must not change or impair the existing ceiling stand.
- The electrical connection must be made outside the installation frame (inspection access).
- The minimum distances given in appendix 2 indicate the free space for air circulation. These must not be reduced or covered by insulation or similar.

Installation steps:

- Create a ceiling cut-out with the dimensions given in appendix 2.
- Connect the heater to the electricity.
- Insert the heater with the flat springs (1) in the ceiling cut-out, press the coil spring (2) back at the installation frame and also insert this side in the ceiling cut-out.
- Position the retaining springs (2) against the inside of the ceiling cut-out.

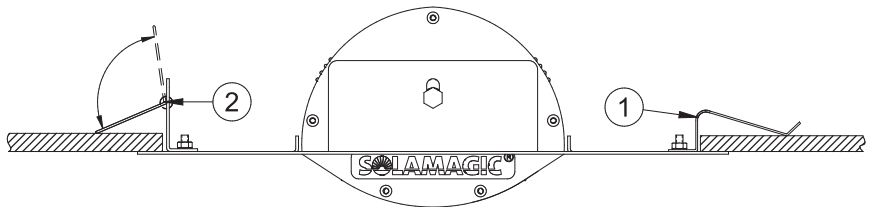

5. Other attachment methods

Please observe the special assembly instructions supplied with the additional accessories.

Initial operation

The heater must be connected to the mains. For those models without a wall or pull switch, heating starts as soon as the plug is plugged into the socket. For models with a wall or pull switch or a wireless switch, heating starts when the switch is turned on or via the remote control.

If necessary see also the separate operating instructions for the remote control.

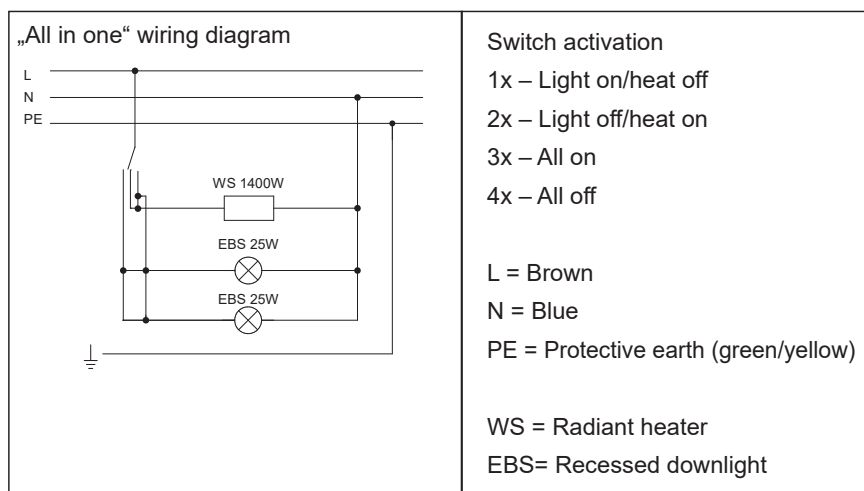

Cleaning instructions

- Disconnect the heater from the mains.
- Allow the casing to cool.
- Wipe the casing clean with a moist, soft cloth. Do not use any detergent.

Never immerse the heater in liquids nor spray-wash it.

Possible discoloration of the protective grille due to heat effects results from normal physical processes and is not a defect.

Replacing the bulb

(„All in one“ version)

Type: Halopin HV halogen lamp 230V 25W matt for G9 bulb fitting

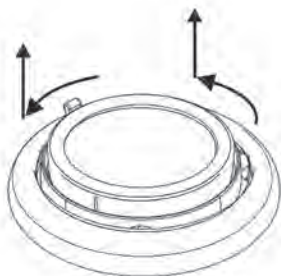

1. Hold the rotating housing on the activation hook, turn the glass retaining ring with glass to the left.

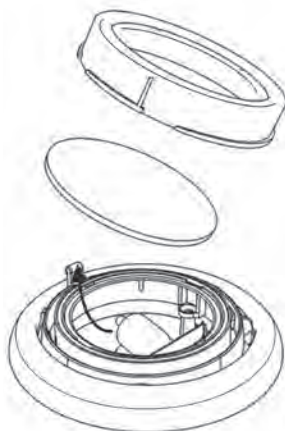

2. Take out the glass and retaining ring.
Pull out the bulb.

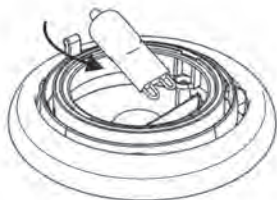

3. Insert new bulb and reassembly the lamp in reverse order.

Troubleshooting / help

Problem: The heater will not switch on.

- In the case of switch-activated models, the switch must be switched on after connection to the mains.
- Have you checked your fuse rating? You require a 16 amp slow fuse for trouble-free operation of your heater.
- Please check whether the IR halogen lamp is broken. If yes, please contact either customer service or the manufacturer.

Problem: The heater does not provide adequate heating.

- Check the radiation angle. The objects to be heated must be located in the direct radiation field.
- Check the distance to the heater and its installation height.
- The heater output is insufficient. Compare the heatable area in the technical data.

Problem: The IR halogen lamp no longer generates any heat.

- The average service life of IR halogen lamps is 5000 hours.
- If the useful service life has elapsed, please contact either customer service or the manufacturer.

Guarantee conditions for Solarmagic heaters

We offer a guarantee for the heaters portrayed in this manual in accordance with the following conditions:

1. We will repair, free of charge, in accordance with the following provisions, damage or defects to the heater, which can be proven to be due to a factory defect, if they are reported to us immediately upon discovery on the heater. The duration of the guarantee for the heater is 2 years, for heaters labelled ECO+ we offer a guarantee extended by 1 year, that is a total of 3 years. The duration of the guarantee for the heating tube is 12 months up to a maximum 5000 operating hours within this period.

The guarantee does not cover minor deviations from the design properties that are irrelevant for the value and usability of the heater. Likewise the guarantee does not cover damage caused by exceptional climatic conditions, abnormal environmental conditions or unsuitable operating conditions. Your dealer will be happy to advise about heater versions for use in such cases. No guarantee can be given if the damage or defects on the heater arise from faulty installation or failure to observe the operating instructions.

2. The guarantee is fulfilled in that defective heaters will be repaired, or replaced by flawless heaters, at our discretion, and free of charge. Heaters for which a performance of guarantee is claimed with reference to this guarantee, must be to be handed over or sent to the manufacturer or an authorized service centre. End consumer labour and material costs are not refunded. Proof of purchase with the date of purchase and/or delivery date plus a detailed description of the fault must always be presented.
3. Any guarantee claim becomes void if repairs or adjustments are made by persons who are not authorised by us or if our heaters are provided with spare parts, supplementary parts or accessories that are not original parts, and have caused a defect. The same applies if the name plate or the heater number has been removed or rendered illegible.
4. Excluded from this guarantee are damage or defects from incorrect connection, improper handling, mechanical damage, particularly to the heating tube, and failure to observe the installation and operating instructions. We accept no liability for consequential damage.
5. Guarantee performances do not extend the guarantee period nor do they initiate a new guarantee period. The guarantee period for any fitted spare parts ends with the guarantee period for the heater as a whole. If a defect or deficiency cannot be eliminated or the rectification of defects is declined by us or unreasonably delayed, an equivalent replacement will be delivered, free of charge, upon the

request of the customer. In case of replacement, we reserve the right to enforce a reasonable usage charge for time of use up until the time of replacement. Replaced heaters become our property.

6. The guarantee only comes into force when the customer has registered their heater with the manufacturer by means of the guarantee card.

These guarantee conditions apply from 01/01/2015 for heaters purchased in a country of the European Union, even if you use it in a foreign country. The guarantee conditions have no effects on the statutory guarantee claim.

Additional instructions

Subject to technical changes

Please note the following terminology in the appendix:

Appendix 1: Surface mounted heaters - technical data, safety distances

①	Heater type	⑧	Dimensions (mm)
②	Product group	⑨	Weight (kg)
③	Power connection	⑩	Average service life (h)
④	Degree of protection * IP 21 for devices with pull switch	⑪	Distance (mm)
⑤	Power (W)	⑫	Ceiling installation
⑥	Protection rating	⑬	Wall installation
⑦	Marking	A	Distance to the side wall
C	Distance to the wall behind	D	Distance to ceiling
E	Distance to the irradiated surface		

Appendix 2: Ceiling mounted heaters - technical data, safety distances

①	Heater type	⑦	Marking
②	Product group	⑨	Weight (kg)
③	Power connection	⑩	Average service life (h)
④	Degree of protection * IP 21 for devices with pull switch	B1	Frame width
⑤	Power	B2	Cut-out width
⑥	Protection rating	L1	Frame length
H3	Ceiling separation	L2	Cut-out length
A	Distance to the side wall	E	Distance to the irradiated surface

Appendix 3: Radiation diagrams

①	Maximum power	②	Heated surface
---	---------------	---	----------------